

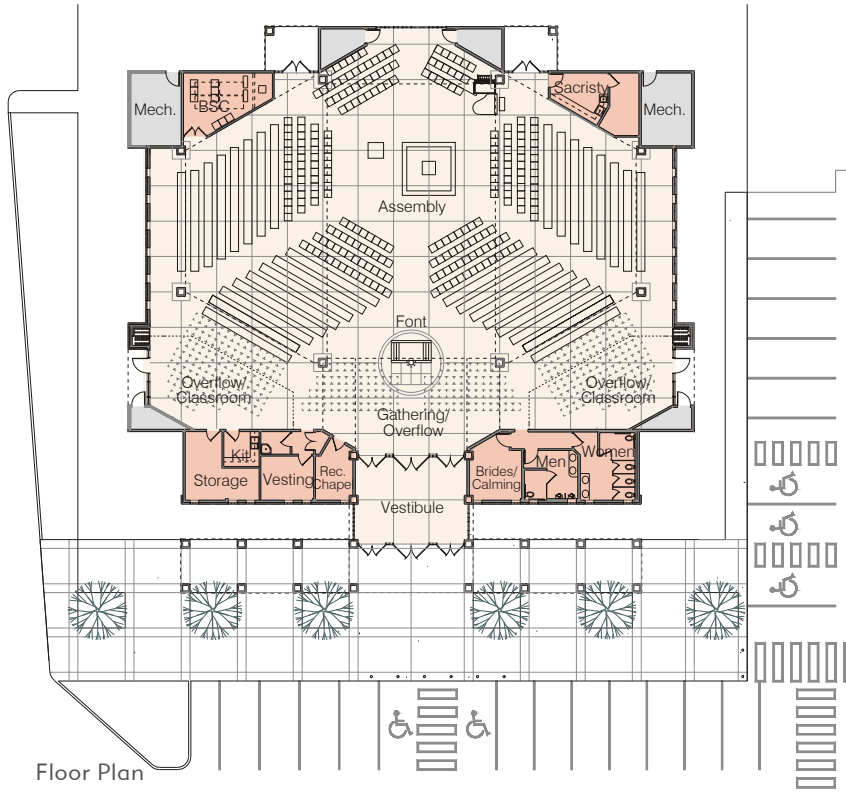

View of Entrance



Floor Plan



CADD Exterior Rendering



Interior of Sanctuary

This new free-standing worship facility encloses 11,200 square feet of space and accommodates 900 people for worship. Construction allows future operable walls that can be installed to create two large meeting spaces for classrooms or parish community use. The new project is located on an existing campus used by the parish for its school, administration and present worship needs.

