



Computer Rendering



Exterior Photo



Interior Rendering



Interior Photo

Because they lacked any stage, gathering space, or significant kitchen facility, the church had developed creative strategies for hosting events and community groups, but they needed to find a more permanent solution to accommodate the growing congregation.

So we developed a multiple-step master plan, and Phase One of construction was completed. Available space required locating the new, 11,000-square-foot, assembly area away from the street, but this also provided room for future expansion and a welcoming entry sequence. Support spaces, including a choir rehearsal room, set-building area, and a large kitchen, allow the new facility to operate independently from the classrooms and offices.

In order to avoid a costly sprinkler system retrofit throughout the existing building, the church opted to keep the new multi-purpose worship center detached until Phase Two. At that time, the old, U-shaped building will finally enclose an interior courtyard with a larger foyer and café. That foyer will provide more direct access to all uses, including several Phase Three additions.

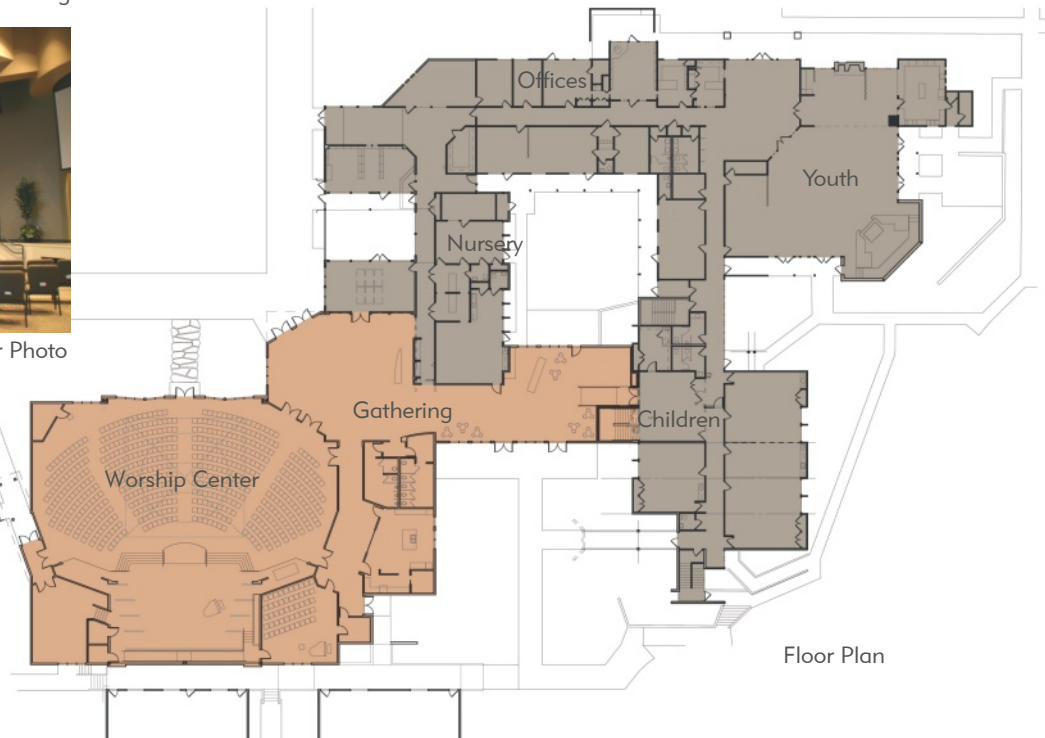

Floor Plan

Our Savior's Baptist had a 24,000-square-foot facility, bursting at the seams with multiple services, activities throughout the week, and a well-established theatrical drama program for outreach and holidays.

