



Exterior View



Sanctuary

- | | | |
|-----------------|------------------------------|----------------------|
| 1 Main Entrance | 4 Social Hall | 5 Restrooms |
| 1A Hallway | 4A Fireside Room | 5A 2-Year Olds |
| 2 Sanctuary | 4B Adult Education | 5B Crawlers/Toddlers |
| 2A Chancel | 4C Classrooms | 7 Youth Room |
| 2B Choir | 4D Kitchen | 7A 4th Grade |
| 3 Reception | 4E 3-4-Yr. Olds | 7B 2nd & 3rd Grades |
| 3A Offices | 4F Kindergarten & 5-Yr. Olds | 7C 5th & 6th Grades |
| 3B Workroom | | 7D Adult Classes |
| 3C Conference | | |
| 3B Workroom | | |

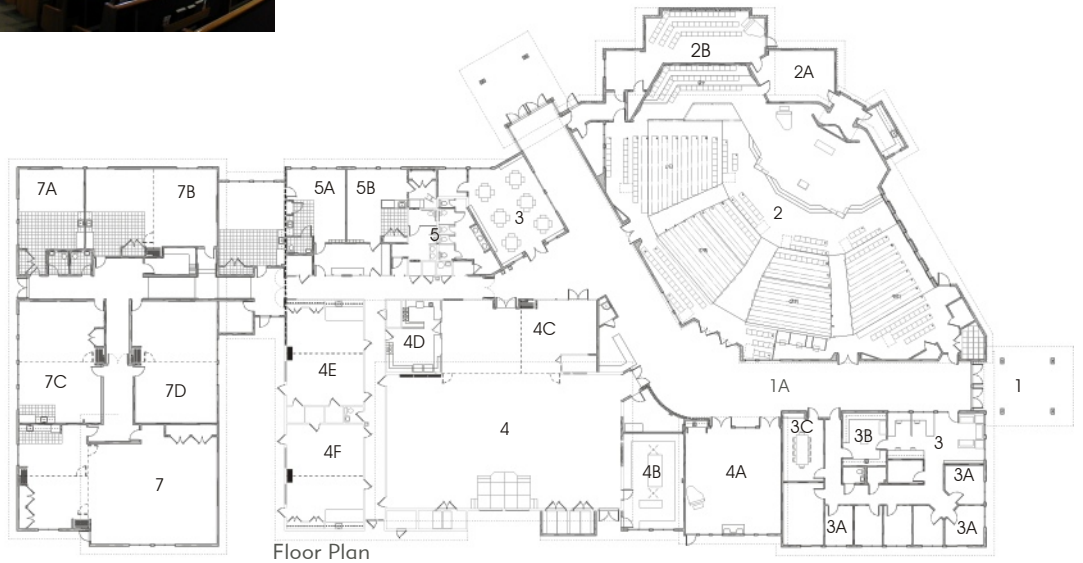

Floor Plan

This project includes a 600-seat sanctuary, narthex, administration suite, fireside room, library, kitchen and classrooms. The Owner used a project manager and served as their own contractor to bring the project in on budget.

