

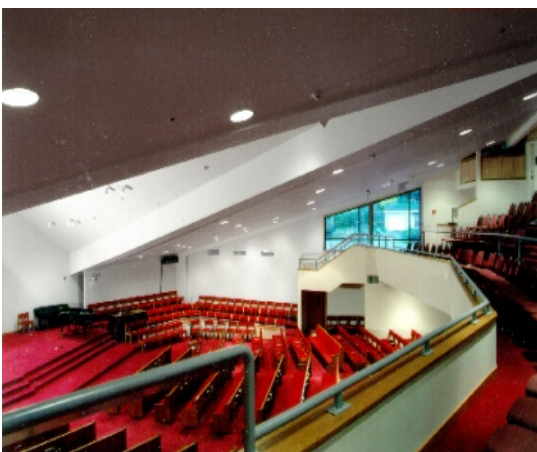

Exterior View of Entrance



Interior View of Sanctuary



Interior View of Sanctuary from Balcony

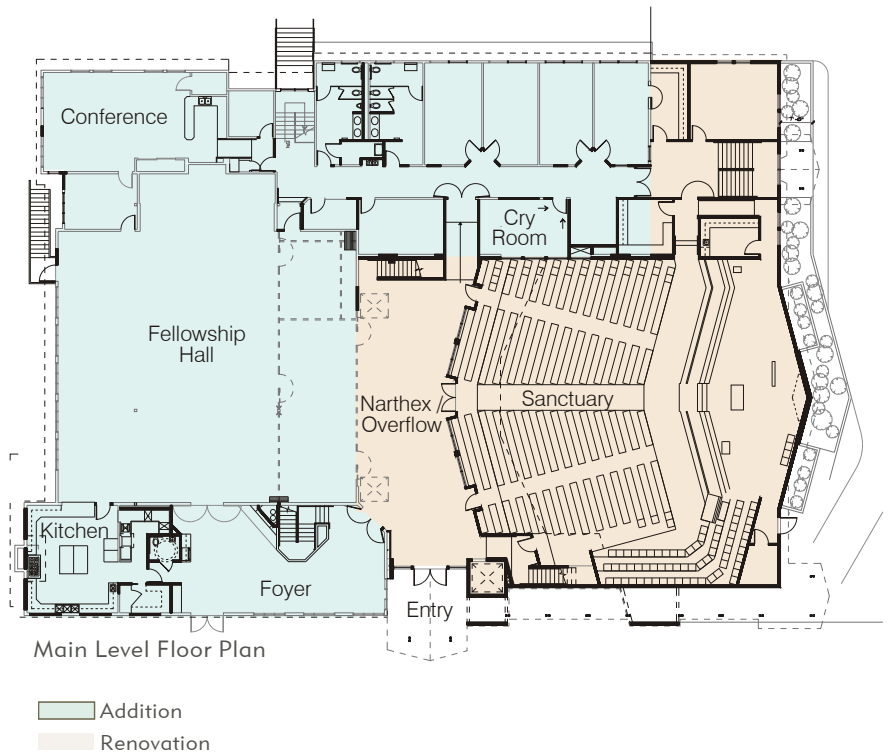

The 17,000-square foot addition includes a 600-seat sanctuary, narthex, and basement with classrooms. The church's desire for a 200-seat balcony was a challenge because of zoning height restrictions. By creating a wedge-shaped roof with a large "dormer" at the altar, the midpoint of the roof was lowered, giving the building a distinctive appearance.

As part of the 30,000-square foot renovation we converted the existing sanctuary into a fellowship hall and over flow space. The church was able to build the addition and remodel the existing building all within their budget because we worked with a negotiated general contract and utilized volunteer labor for much of the renovation.