

Our goal for this project was to provide balanced worship, education and fellowship spaces that would meet the church's ministry needs with their limited budget.



Exterior View



View at Sanctuary

The new 300-seat sanctuary has an overflow "mini fellowship hall" which opens into the sanctuary and forms a large multi-purpose room for large services and events. Other features include a kitchen to support the fellowship hall, nursery and classroom space. Existing buildings on the site provide a temporary home for office and additional classroom functions. Our master plan includes Phase II plans for a future multi-purpose education, fellowship/gymnasium building.

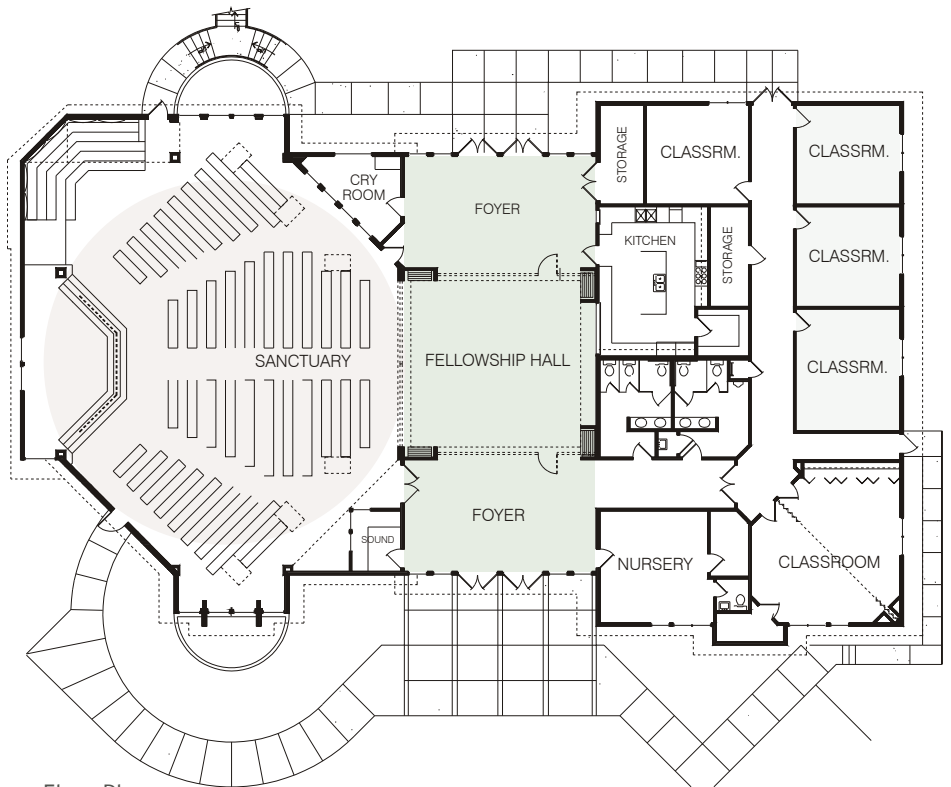

Floor Plan

