



View from Street



Interior View of Sanctuary



Computer Rendering of Foyer



Exterior View of Main Entry

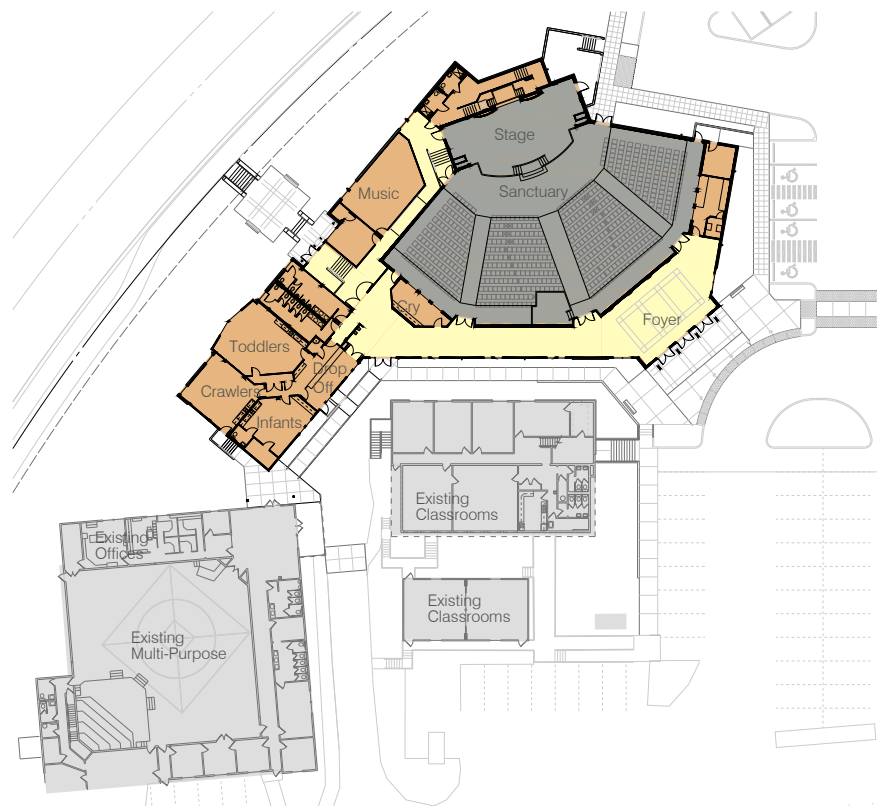

Main Level Floor Plan

Christ's Church of Federal Way is a growing congregation. Meeting for several years in an adjacent middle school gym, they wanted to build an auditorium on their site to meet their worship needs. BPH provided a master plan that integrated an 850-seat auditorium style worship center (with future balcony), new foyer and nursery space, expanded fellowship hall, new office wing, and 2-story classroom addition with existing buildings on site. Phase I included the auditorium, nursery, part of the foyer, revised parking layout on site and a new shared parking lot on the adjacent school property.

