



Exterior View

We started with a master plan, which included 3 phases totaling 33,500 SF on a 5-acre site. Phase I was then completed with 13,000 SF of space, including a multipurpose worship center / fellowship hall / gymnasium. We also provided an inviting foyer space, offices, nursery, classrooms, and kitchen.

We designed a church that would loosely resemble a lodge style building that would fit in with the site, which is in close proximity to Mt. Si. We balanced the programmed space and the quality design of the building with a limited budget for Phase I.

During the design process, we were able to create 3D CAD renderings to help the client visualize the project and build enthusiasm for fund raising.



Multi-Purpose Sanctuary



Exterior Rendering

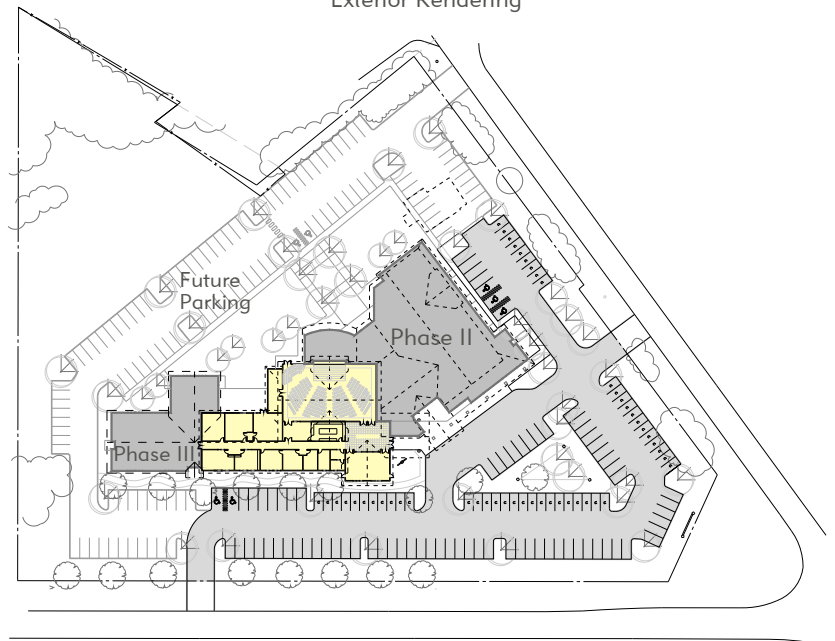

Master Site Plan

