

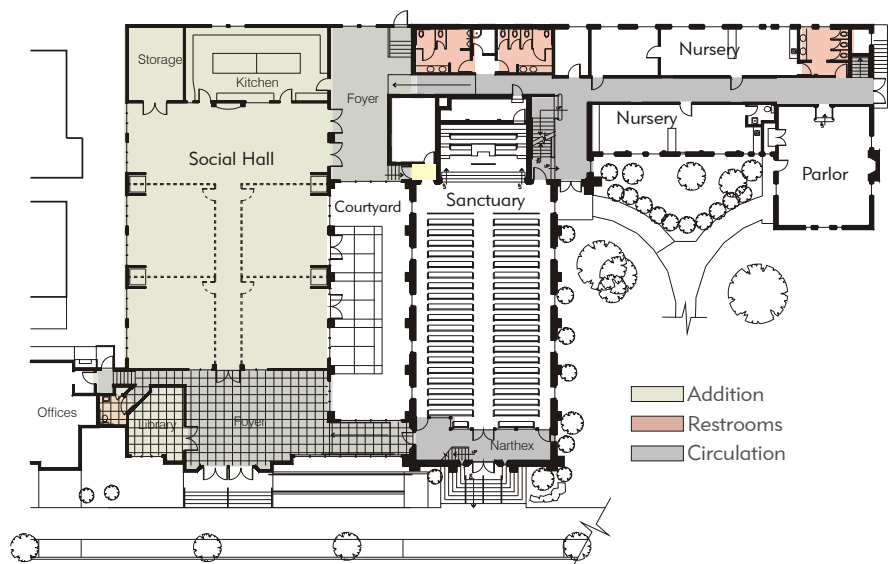

West Elevation



View at the Entry.



Main Floor Plan / Site Plan



Streetscape at the Entry.

This project added a 6,700-square foot fellowship hall to an existing historic landmark church on Queen Anne Hill in Seattle. Portions of the existing 12,800-square foot church building were remodeled including converting the existing fellowship hall into classrooms. A 2800-square foot residence was given a fresh look and was converted to church offices connected to the new foyer.

The design of the addition incorporates elements that complement and respect the historic church building. The link between the two buildings provides a well-detailed transparent link that unifies the existing structures in a sensitive manner.